

XT-3815-G2

POSIFLEX

Specification	XT-3815-G2
Processor	Intel Elkhart Lake Celeron J6412, up to 2.60 GHz, 1.5M Cache
System Memory	DDR4 SO-DIMM x 2, max. 32GB
Storage Device	M.2 connector [supporting AHCI mode] x 2
RAID Function	N/A
Intel vPro Support	N/A
TPM Support	Yes, TPM 2.0
Power Supply	12V/60W
OS Support	Windows 10 IoT LTSC / Windows 11 IoT LTSC

Display & Touch	
LCD	15" TFT LCD
Resolution	1024 x 768
Touch	True-flat PCAP touch with multi-touch support (IP65 on front panel)

I/O & Expansion	
Serial Port	6, DB9 x 3 + RJ45 x 1 + 2 via optional converter cable from service window, 5V support on all COM ports, 12V support on COM1 to COM 4 (all converter cables are optional)
Parallel Port	1, via optional conversion cable through service window
Standard USB Port	7, USB 3.0 x 3 + USB 2.0 x 4
PoweredUSB Port	Optional 24V x 1 + 12V x 3 via GEN8E base
LAN Port	10/100/1000 Mb x 1
Display Port	VGA x 1, 12V support for Posiflex monitors
CR Port	1, control 2 CR via optional Y-cable, supporting 12V cash drawer
PS/2 Port	1, via optional conversion cable through service window
UPS Port	Yes, battery optional
Audio	Internal 2W speaker x 1
Expansion Slot	M.2 slot x 1

Physical Dimension	
Dimensions (W x D x H in mm)	372 x 252.7 x 320
Weight (N. W. in kg)	6

Environmental	
Operating Condition	0°C - 40°C, 20%RH - 90%RH
Storage Condition	-20°C - 70°C, 10%RH - 90%RH

Built-in Options	
WiFi	M.2 WiFi/BT module

Attachment Options	
POS Monitor	Non-touch TFT LCD: 7"/9.7"/12.1"/14"/15"; PCAP touch TFT LCD: 9.7"/14"/15"; Resistive touch TFT LCD: 15"
Line Display	2 x 20 rear-mount VFD/LCD customer line display; 7" color LCD graphical customer line display
Attachment	MSR; iButton; Rotatable 2D Scanner; RFID; Fingerprint Sensor; Keypad

Flexible! Powerful! Elegant!



XT-3815-G2

Fanless POS Terminal

*Designed and Manufactured in Taiwan by Posiflex Technology, Inc.

*The product information and specifications are subject to change without prior notice.

*Please refer to the website for more attachment options.

Certifications		EN20240314V1
----------------	--	--------------

POSIFLEX

POSIFLEX TECHNOLOGY, INC.

No. 23, Datong St., Tucheng Dist., New Taipei City 23679, Taiwan
Tel : +886-2-2268-5577 E-mail : sales@posiflex.com.tw
Fax : +886-2-2268-5388 www.posiflex.com

Authorized Distributor / Reseller



In today's retail and hospitality markets, POS terminal is no longer just a cold and hard business tool. It is a part of the store decoration, a part of the store image. Each curve and detail of the POS terminal should add something to the overall mood of the store, to lift the shopping experience of customers.

The XT-3815-G2 features a 15" true-flat PCAP touch screen, beautifully sculptured slim body, and sexily curved base stand, it looks right at home at any elegantly decorated store. More than just good looks, the XT-3815-G2 offers ample of performance and flexibility to satisfy the most demanding daily POS operations.

Sleek Look

The XT-3815-G2 comes from new Posiflex design language. Slimmer than ever, it is a sharp departure from the traditionally conservative Posiflex terminal design. Every curve and detail of the XT-3815-G2 is carefully thought out to make itself one of the most visually desirable terminals in the market.

Performance

Equipped with an Intel Elkhart Lake processor, the XT-3815-G2 delivers incomparable performance and is powerful enough to process anything throws at it without even breaking a sweat.

Multi-Position Folding Base (U.S. Patent 9004436)

The XT-3815-G2 provides the selection of two foldable bases, the curvy slim GEN7E base and the larger but practical GEN8E base. The foldable base can be configured into "Flat Folded Mode" to save the shipping package volume, "Low Profile Mode" to allow greater interaction between the cashier and the customer, and the traditional "Full Extended Mode". All this can be achieved with a simple pull of the hidden lever.



Full Extended Mode



Low Profile Mode



Flat Folded Mode

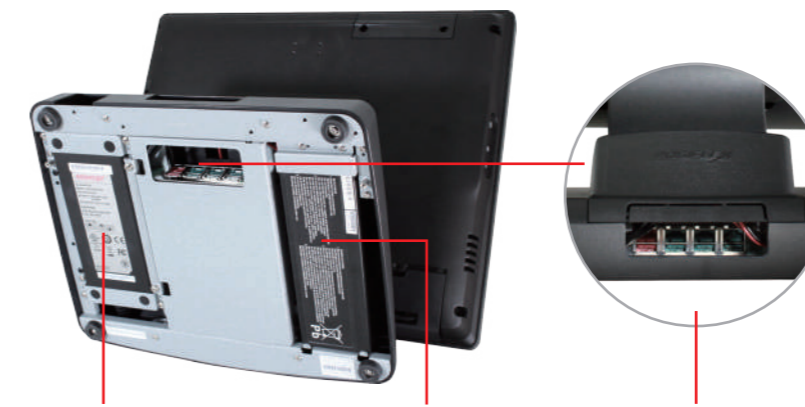

Power Adaptor

UPS Battery

PoweredUSB Ports

Patented Fanless Technology

Fanless design not only allows the XT-3815-G2 to function well in harsh environment, it also enables the terminal to run quietly in places such as retail stores or hospitals, where silent operation is of utmost importance.

GEN8E Base (U.S. Patent 9004436)

Optional GEN8E base integrates internal power adaptor and PoweredUSB port into the base stand, which keeps counters clutter-free.